

Scale: 1:15,000 Projection Information: UTM Nad83 Zone 11

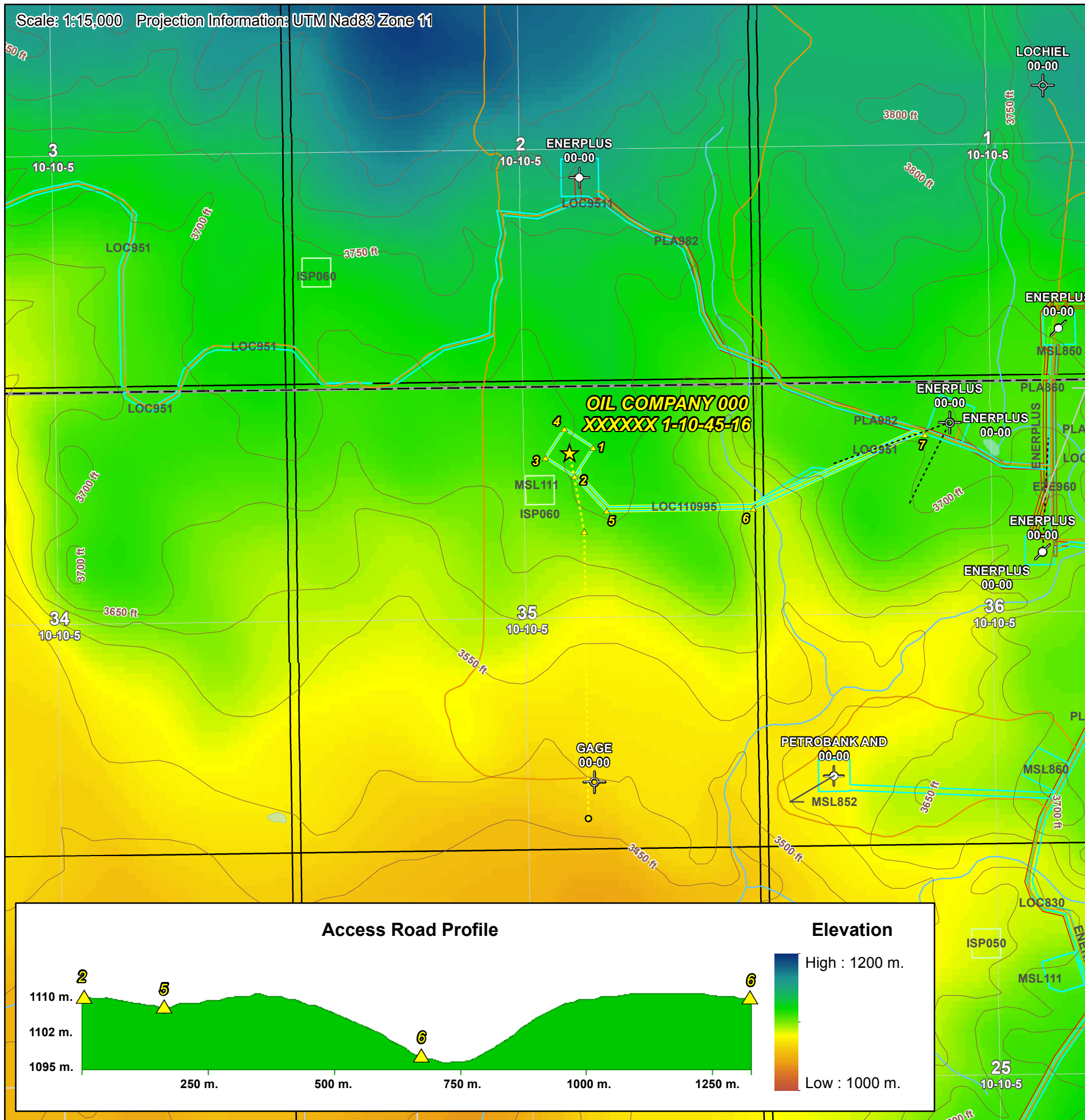

Oil Company LOGO

**OIL COMPANY 000
XXXXXX 1-10-45-16**
with
Canadian Digital Elevation Data

Drawing Notes

Date: June 17, 2011
File No.: 11000G010
Job No.: 11-0000
Photo Date: Sept. 1999
Paper Size: 1.3 sq ft (11"x17")

Area Required

Area	Acres	Hectares
Well Site	3.6	1.4
Access Road	4.9	2.0
Total	8.5	3.4

- Wells / Pipelines**
- ★ Proposed Well center
- Oil
- ☼ Gas
- ⊙ Standing
- ⊕ Abandoned Oil
- ⊖ Abandoned
- ⊗ Suspended Oil
- ⊘ Suspended
- ⊙ Other
- ⋯ Directional Well Paths
- Pipelines
- ⊕ Well sites
- Pipelines R/W's
- Road and Railway R/W's
- Subdivision Boundaries
- Easement R/W's
- Others
- Dispositions**
- Other
- PLA
- LOC, MLL, MSL
- PIL
- REC
- ROE
- SMC, SME, SML
- EZE
- VCE
- ISP

Coordinates

Name	Northing	Easting	Locals
OIL COMPANY 000 XXXXXX 1-10-45-16 SH	1234567.0	1234567.0	111.1 S 111.1 W
OIL COMPANY 000 XXXXXX 1-10-45-16 BH	1234567.0	1234567.0	111.1 S 111.1 W
1	1234567.0	1234567.0	111.1 S 111.1 W
2	1234567.0	1234567.0	111.1 S 111.1 W
3	1234567.0	1234567.0	111.1 S 111.1 W
4	1234567.0	1234567.0	111.1 S 111.1 W
5	1234567.0	1234567.0	111.1 S 111.1 W
6	1234567.0	1234567.0 </td <td>111.1 S 111.1 W</td>	111.1 S 111.1 W
7	1234567.0	1234567.0	111.1 S 111.1 W
ICP	1234567.0	1234567.0	111.1 S 111.1 W

Well site Detail

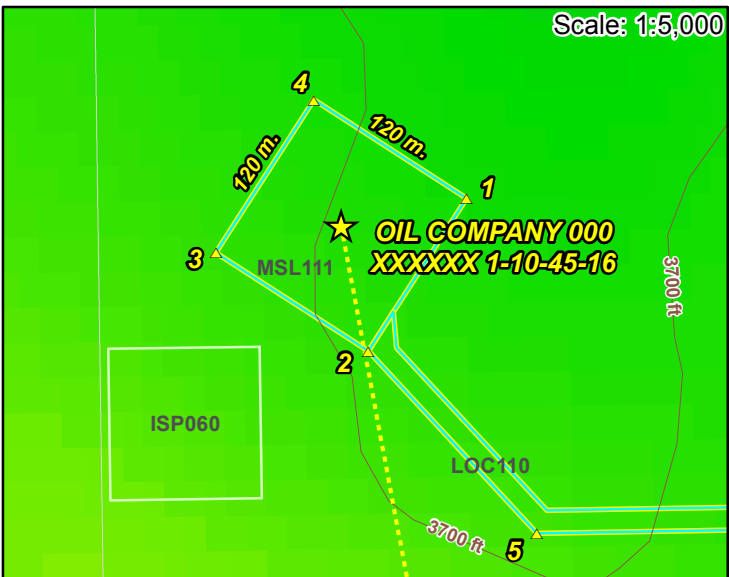

Disposition Notes

Wildlife Sensitivities:
In one Zone

Significant Historic Sites: Not Within

County:
County in Alberta

Strike Area: Alberta Strike

Drawing prepared by
AE All-Can Engineering & Surveys (1976) Ltd.

Access Road Profile

